

NCM

NFPA Standard Mini Cylinder



Specifications

Bore(mm)	16(9/16")	20(3/4")	25(1-1/16")	32(1-1/4")	40(1-1/2")
Acting type	Double Acting				
Working medium	Clean Air(40 μ m filtration)				
Working pressure (psi)	15~100	14.5~145			
Guaranteed pressure (psi)	160	215			
Working temperature (°C)	-20~70°C (-4~176°F) (No freezing)				
Speed range (mm/s)	50~800				
Cushion type	Rubber cushion				
Barrel material	Stainless Steel				
Mounting type	LB SDB				
Port size	No.10~32	NPT1/8			
Magnet switch	HX-03				

How to Order?

Series No	Cushion Type	Type No	Bore	X	Stroke	Magnet No	Tail Type	Mounting Type
NCM (North American Standard)	Blank: Rubber cushion	Blank: Basic type D: Double shaft type	16(9/16") 20(3/4") 25(1-1/16") 32(1-1/4") 40(1-1/2")		*Stroke length must be indicated as 4 digits. First and second digit: Stroke/Inch Third and fourth digit: Stroke/Hundredth of an inch Example) 0525=5.25(5-1/4) inch stroke Details in stroke chart	S: With magnet	Blank: Swiveling tail R: Axial air-in	Blank: No LB SDB YJ

Order Example:

NCM series, Double shaft type, Bore 32 mm, stroke 2 inch, with magnet, No Mounting type, Swiveling tail.

ERP code is: NCMD32 x 0200-S

Note: If using a cylinder with different mounting accessories, please use this sequential coding: LB/SDB/YJ

Stroke

Bore Size	Standard Stroke (inch)	Max. Stroke (inch)
16(9/16")	1/2 1 2 3 4 5 6 7 8 9 10	20
20~40(3/4"~1-1/2")	1/2 1 2 3 4 5 6 7 8 9 10 15 20	30

Internal Structure

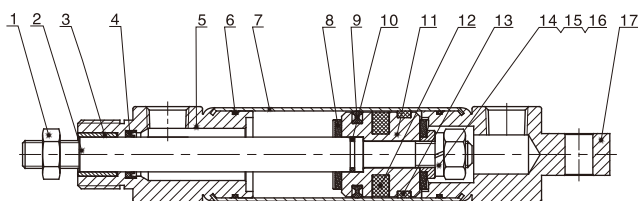

NO.	Part Name	Material
1	Nut	Carbon steel
2	Piston rod	S45C hard chrome carbon steel
3	Self lubricating bearing	Bronze powder
4	Piston rod seal	NBR
5	Head cover	Aluminum alloy
6	O-ring	NBR
7	Barrel	Stainless Steel
8	Cushion pad	NBR
9	Piston seal	NBR
10	O-ring	NBR
11	Piston	Aluminum alloy
12	Magnet	Plastic
13	Wear ring	PTFE
14	Pressing pads	Carbon steel
15	Spring washer	Carbon steel
16	Nut	Carbon steel
17	Rear cover	Aluminum alloy

NCM Series NFPA Standard Mini Cylinder



Main Dimension

NCM $\Phi 16$

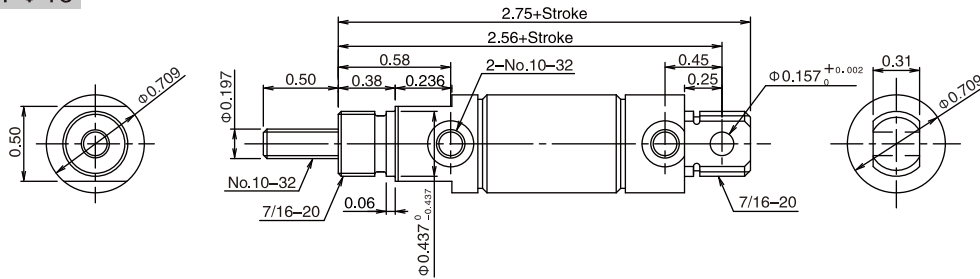

NCM $\Phi 20-\Phi 40$

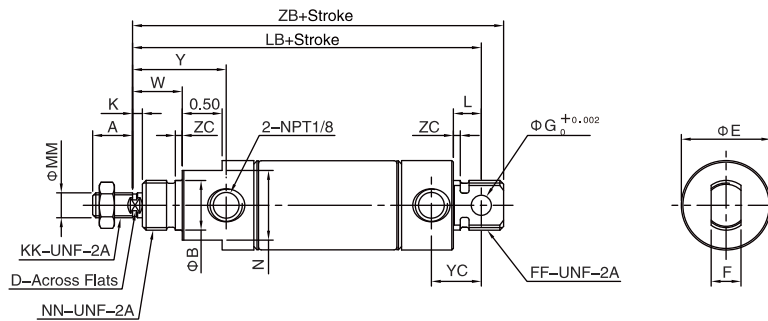

Bore	MM	KK	A	B	D	E	F	FF	ΦG	K	L	N	NN	W	Y	YC	LB	ZB	ZC
20(3/4")	0.250	1/4-28	0.50	0.622 ⁰ _{-0.003}	-	0.87	0.38	5/8-18	0.252	-	0.34	0.75	5/8-18	0.50	0.815	0.654	3.75	4.03	0.08
25(1-1/16")	0.312	5/16-24	0.50	0.622 ⁰ _{-0.003}	0.25	1.12	0.38	5/8-18	0.252	0.12	0.34	0.88	5/8-18	0.62	0.933	0.654	3.84	4.12	0.08
32(1-1/4")	0.472	7/16-20	0.75	0.748 ⁰ _{-0.003}	0.38	1.38	0.50	3/4-16	0.252	0.25	0.41	1.06	3/4-16	0.88	1.283	0.811	4.47	4.87	0.08
40(1-1/2")	0.472	7/16-20	0.75	0.748 ⁰ _{-0.003}	0.38	1.65	0.62	3/4-16	0.378	0.25	0.50	1.25	3/4-16	0.88	1.268	0.886	4.38	4.75	0.08

Note: 1. With magnet and without magnet, the dimensions are same.