

ERL600

Vacuum Generator

Vacuum Flow: 600NL/min



Application/Features

- Products using multistage vacuum tube, engraved widely used in many industries.
- High vacuum flow rate and short corresponding time.
- Centralized air supply, optional air supply, destroy solenoid valve control.
- External silencer structure.

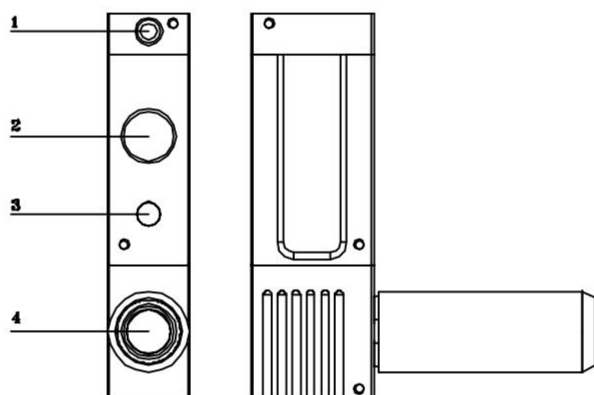

- 1、 Air supply port(G1/4)
- 2、 Vacuum port1 (G3/4) Vacuum suction cup port
- 3、 Vacuum port 2 (G3/4) Vacuum monitoring port
- 4、 Muffler exhaust port(G3/4)

How to Order?

Series No.	Vacuum Tube Type	Exhaust Method	Solenoid Valve Control	With Or Blank Vacuum												
ERL600: ERL600 Series	H: -94 kPa L: -74 kPa	Blank: External muffler (default) P: Port exhaust	<table border="1"> <thead> <tr> <th>Code</th> <th>Supply Valve</th> <th>Break Valve</th> </tr> </thead> <tbody> <tr> <td>Blank</td> <td>Blank</td> <td>Blank</td> </tr> <tr> <td>K1</td> <td>●</td> <td>Blank</td> </tr> <tr> <td>K2</td> <td>●</td> <td>●</td> </tr> </tbody> </table>	Code	Supply Valve	Break Valve	Blank	Blank	Blank	K1	●	Blank	K2	●	●	Blank: Blank (default) C: with Vacuum pressure gauge
Code	Supply Valve	Break Valve														
Blank	Blank	Blank														
K1	●	Blank														
K2	●	●														

Order Example: ERL600 Series vacuum generator, exhaust specification, Exhaust port, supply valve control, with vacuum pressure gauge. The order code is ERL600H-P-K1-C

Performance Parameter

Specifications And Models	Supply Gas Pressure(MPa)	Maximum Vacuum Degree(-kPa)	Maximum Vacuum Flow(NL/min)	Gas Consumption (NL/min)	Recommended Diameter Of Air Supply Port (mm)	Recommended Pipe Diameter For Vacuum Port (mm)
ERL600H-	0.5	94	600	270	8	12
ERL600L-	0.5	74	600	270	8	12

ERL600

Vacuum Flow Rate Of Different Vacuum Degrees (-kpa) (NL/min)

Specifications And Models	Supply Gas Pressure(MPa)	Gas Consumption NL/min	0	10	20	30	40	50	60	70	80	90	Maximum Vacuum Degree(-kPa)
ERL600H-	0.5	270	600	360	240	156	88	70	52	38	22	4	94
ERL600L-	0.5	270	600	345	230	160	86	60	45	31	--	--	74

Suction Time Of Different Vacuum Degrees (-kpa) (s/L)

Specifications And Models	Supply Gas Pressure(MPa)	Gas Consumption NL/min	0	10	20	30	40	50	60	70	80	90	Maximum Vacuum Degree(-kPa)
ERL600H-	0.5	270	0	0.014	0.031	0.06	0.10	0.20	0.34	0.50	0.80	2.50	94
ERL600L-	0.5	270	0	0.01	0.02	0.05	0.09	0.17	0.27	0.40	--	--	74

ERL600 Vacuum Flow Rate Of Different Vacuum Degrees (-kpa) (NL/min)

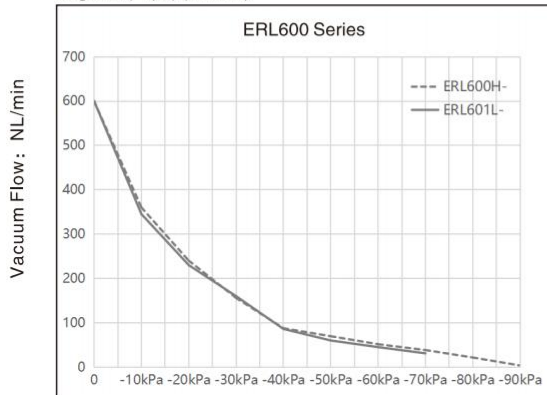

Vacuum Degree: -kPa

ERL600 Suction Time Of Different Vacuum Degrees (-kpa) (s/L)

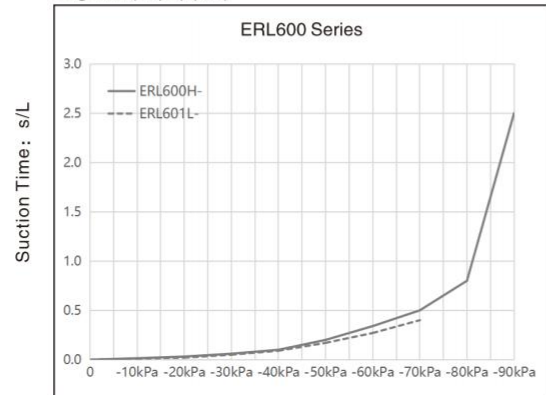

Vacuum Degree: -kPa

Main Dimension

ERL600-□ (Standard)

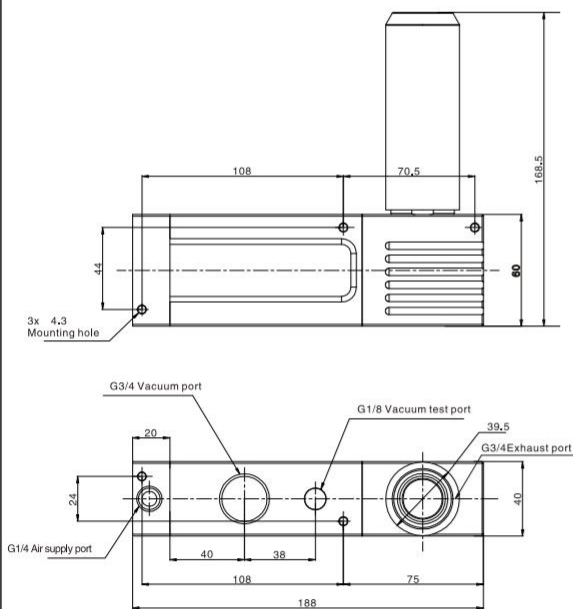

ERL600-□-P (Ventilation)

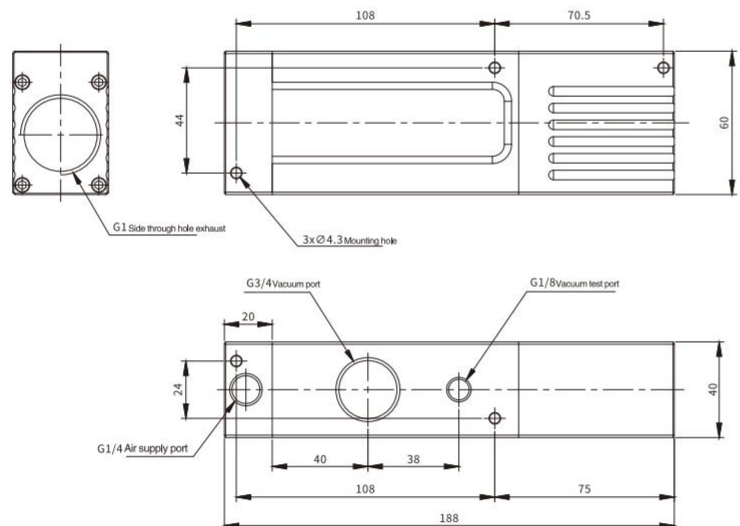

ERL600 Series Vacuum Generator



○ Main Dimension

ERL600-□-K2(Solenoid valve control)

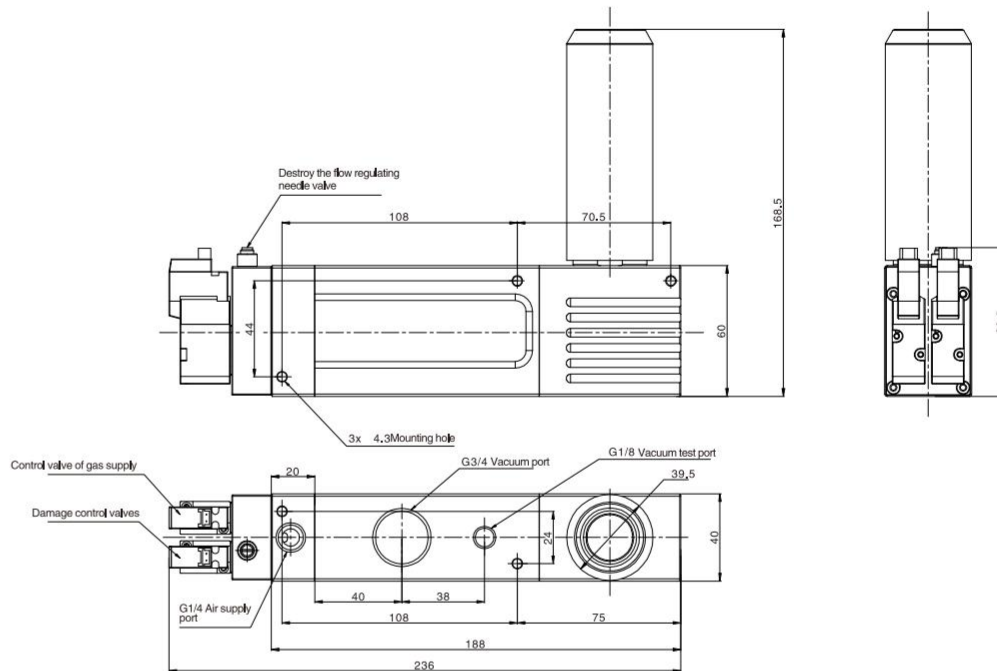

ERL600-(Mounting dimension)

