

## VT

### Flow Control Valve



#### Product Features

- Adopt small orifice throttling mode, realize vacuum tube diameter reduction function.
- Suit for maintain the system vacuum by reducing separate Pad's flow rate.
- Installed in any position and direction in the system.

#### How to Order?

Series No.	Throttle Hole Specification		—	Thread Specification
VT: VT Series	25: $\phi$ 0.25mm	100: $\phi$ 1.00mm		G18M: G1/8 Male thread
	40: $\phi$ 0.40mm	120: $\phi$ 1.20mm		G14M: G1/4 Male thread
	60: $\phi$ 0.60mm	150: $\phi$ 1.50mm		
	80: $\phi$ 0.80mm	200: $\phi$ 2.00mm		

**Order Example:** VT Series Flow Control Valve, throttle hole 0.25mm, G1/8 male thread. Order code is: VT25-G18M

#### Performance Parameters

Model No.	Suction Flow Required Under -30kPa( NL/min)	Suction Flow Required Under -60kPa( NL/min)	G18M Weight (g)	G14M Weight (g)
VT25-□	0.2	0.3	6.0	8.0
VT40-□	1.0	1.2	6.0	8.0
VT60-□	3.1	3.2	6.0	8.0
VT80-□	5.0	5.2	6.0	8.0
VT100-□	7.7	8.5	6.0	8.0
VT120-□	12.5	12.8	6.0	8.0
VT150-□	22.2	23.5	6.0	8.0
VT200-□	34.0	36.5	6.0	8.0

#### Main Dimension

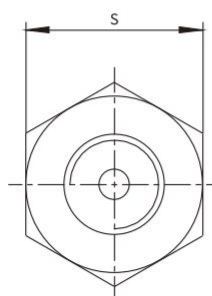
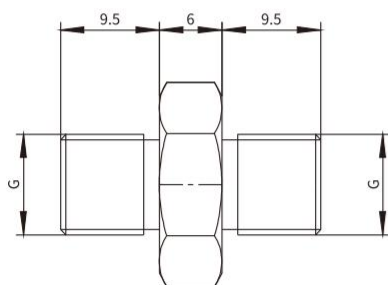

Model No.	G	S (mm)
VT□-G18M	G1/8	14
VT□-G14M	G1/4	17