

SZP

Traceless Resin Accessories



Product Features

- No traces of suction marks (rubber components) remain on the workpiece, because the organ-type rubber suction cups are fitted with attachments made of PEEK material, thus avoiding contact between the workpiece and the rubber material and preventing the rubber components from spilling out ;
- The rubber component of the suction cup is attached to the workpiece ;
- SZP series organ type (Ø6~Ø32) is the most suitable ;

How to Order?

Series No.	Applicable pad	Material
SZP 2: SZP 2 Series	06: SZP06B□ 10: SZP10B□ 16: SZP16B□ 20: SZP20B□ 25: SZP25B□ 32: SZP32B□	PK: PEEK

Application

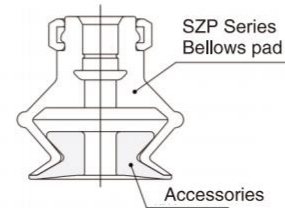

Order Example:

SZP series traceless resin accessories, suit for SZP06B, material is PEEK
Order code is SZP2-06PK

- This accessories can only be mounted inside EMC' s standard bellows pads
- Clean the product before using the accessories.
This product is not cleaned after production.
If the product is used in the condition , residual material may be left on workpieces.Clean before use

Main Dimensions

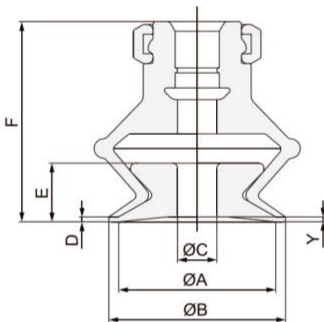

Model	Applicable pad models	A	B	C	D	E	F	Y
SZP2-06PK	SZP06B□	6	7	1.6	0.5	3	13.5	0.5
SZP2-10PK	SZP10B□	10	12	3.5		3.5	16.5	
SZP2-16PK	SZP16B□	16	18	4		6	20.5	
SZP2-20PK	SZP20B□	20	22	8	1	8.5	24.5	1
SZP2-25PK	SZP25B□	25	27	10			25	
SZP2-32PK	SZP32B□	32	34				11.5	