

SJ

Mini Type Cylinder

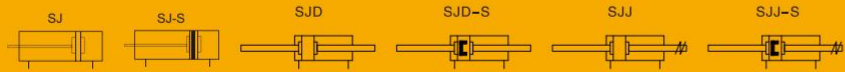

Specifications

Bore size(mm)	6	10	12	16
Acting type	Double Acting			
Working medium	Clean Air(40 μ m filtration)			
Working pressure (MPa)	0.1~0.7			
Guaranteed pressure (MPa)	1.0			
Working temperature (°C)	-20~70(No freezing)			
Speed range (mm/s)	50~750			
Cushion type	Rubber cushion on both ends			
Port size	M5x0.8			

How to Order?

Series No.	Type No.	Bore X Stroke	Magnet No.	Tail Type
SJ	Blank: Basic type	6 10	Blank: No magnet	U: Flat tail (Radial intake type)
	D: Double shaft type	10 15	S: With magnet	CB: Double U-type (Radial intake type)
	J: Double shaft and adjustable stroke type	12 20		CM: Round tail (Radial intake type)
		16 ...		R: Axial intake type
(Note: Only U or R optional for Ø6)				

Order Example:

SJ series cylinder, basic type, 10mm bore, 50mm stroke, with magnet, flat tail, the ERP code is: SJ10x50-S-U
 Note: SJ6 has no double shaft type, the double shaft and adjustable stroke type is optional.

Optional Accessories

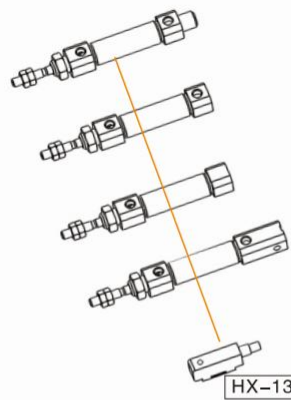

Stroke

	Bore (mm)	Standard Stroke (mm)	Max. Stroke (mm)
	Double Acting	6	10 15 20 25 30 40 50 60
10		10 15 20 25 30 40 50 60 75 80 100 125 150 160 175 200	200
12		10 15 20 25 30 40 50 60 75 80 100 125 150 160 175 200	200
16		10 15 20 25 30 40 50 60 75 80 100 125 150 160 175 200	200

SJ Series Stainless Steel Mini Cylinder



Internal Structure

SJ06

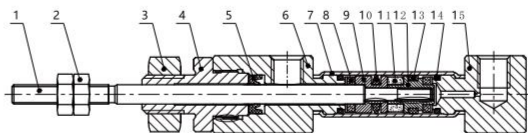

No.	Part name	Material
1	Piston rod	S45C hard chrome carbon steel
2	Nut	Carbon steel
3	Nut	Carbon steel
4	Outer cover	Brass
5	Piston seal	Aluminum alloy
6	Head cover	Aluminum alloy
7	Barrel	Stainless steel
8	Anti-bump cushion	TPU
9	Piston	SUS304
10	Piston seal	NBR
11	Magnet	RbFeb
12	Magnet Base	SUS304
13	Wear ring	PTFE
14	O-ring	NBR
15	Rear cover	Aluminum alloy

SJ010, 012, 016

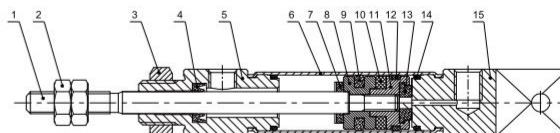

No.	Part name	Material
1	Piston rod	S45C hard chrome carbon steel
2	Nut	Carbon steel
3	Nut	Carbon steel
4	Head cover dust ring	NBR
5	Head cover	Aluminum alloy
6	Barrel	Stainless steel
7	Anti-bump cushion	TPU
8	Piston	Ø10:SUS304 Ø16: Aluminum alloy
9	Piston seal	NBR
10	Magnet	RbFeb
11	Magnet Base	Ø10:SUS304 Ø16: Aluminum alloy
12	Wear ring	PTFE
13	Anti-bump cushion	TPU
14	O-ring	NBR
15	Rear cover	Aluminum alloy

Main Dimension

SJ06

U Type

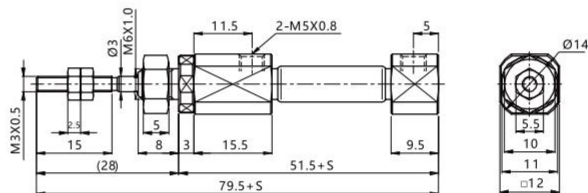

R Type

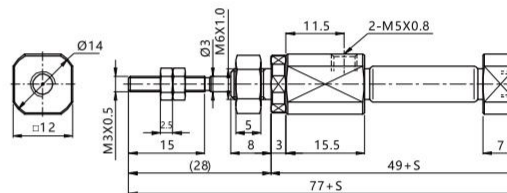

SJ010, 012, 016

CB Type

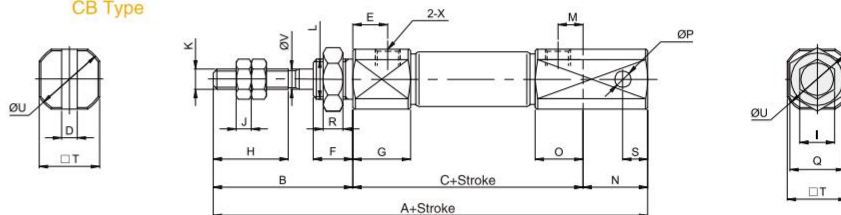

U Type

Total length=A1+Stroke

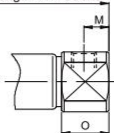

CM Type

Total length=A2+Stroke

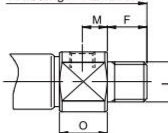

R Type

Total length=A1+Stroke

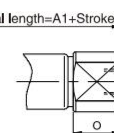

Bore/Sign	A	A1	A2	B	C	D	E	F	G	H	I	J	K	L	M	N	O	P	Q	R	S	T	U	V	X
10	87	74	82	28	46	3.2	7	8	11.5	15	7	3	M4X0.7	M8X1.0	5	13	9.5	3.3	11	4	5	12	14	4	M5X0.8
12	92	71	82	28	46	6.5	7.5	8	12	15	8	4	M5X0.8	M10X1.0	5	18	9.5	5	14	4	8	15	17	5	M5X0.8
16	93	75	83	28	47	6.5	7.5	8	12.3	15	8	4	M5X0.8	M10X1.0	5	18	9.5	5	14	4	8	18.3	19.7	5	M5X0.8