

Compact67 IO-Link HUB



Product Features

- High degree of protection IP67.
- Use IO-Link V 1.1 normative design.
- Support COM2 communication rate.
- For input or output, NPN or PNP signal type is optional.
- M12 or M8 IO connections optional.
- Status indication via LED, channel-specific protection and diagnostics.

How to Order?

IO-Link Input/Output Modules-M12

Series NO	I/O	Digital Output	Connection type
ESLK	1600: 16DI 088U: 8DI+8DIO 16U: 16DI/DO	P: PNP N: NPN	M12: M12 signal connection

Order Example: ESLK series, 16DI, PNP output modules, M12 signal connection, EPR code is: ESLK-1600P-M12

IO-Link Input/Output Modules-M8

Series NO	I/O	Digital Output	Connection type
ESLK	0800: 8DI 08: 8DI/DO	P: PNP N: NPN	M8: M8 signal connection

Order Example: ESLK series, 8DI, PNP output modules, M8 signal connection, EPR code is: ESLK-0800P-M8

IO-Link Interface

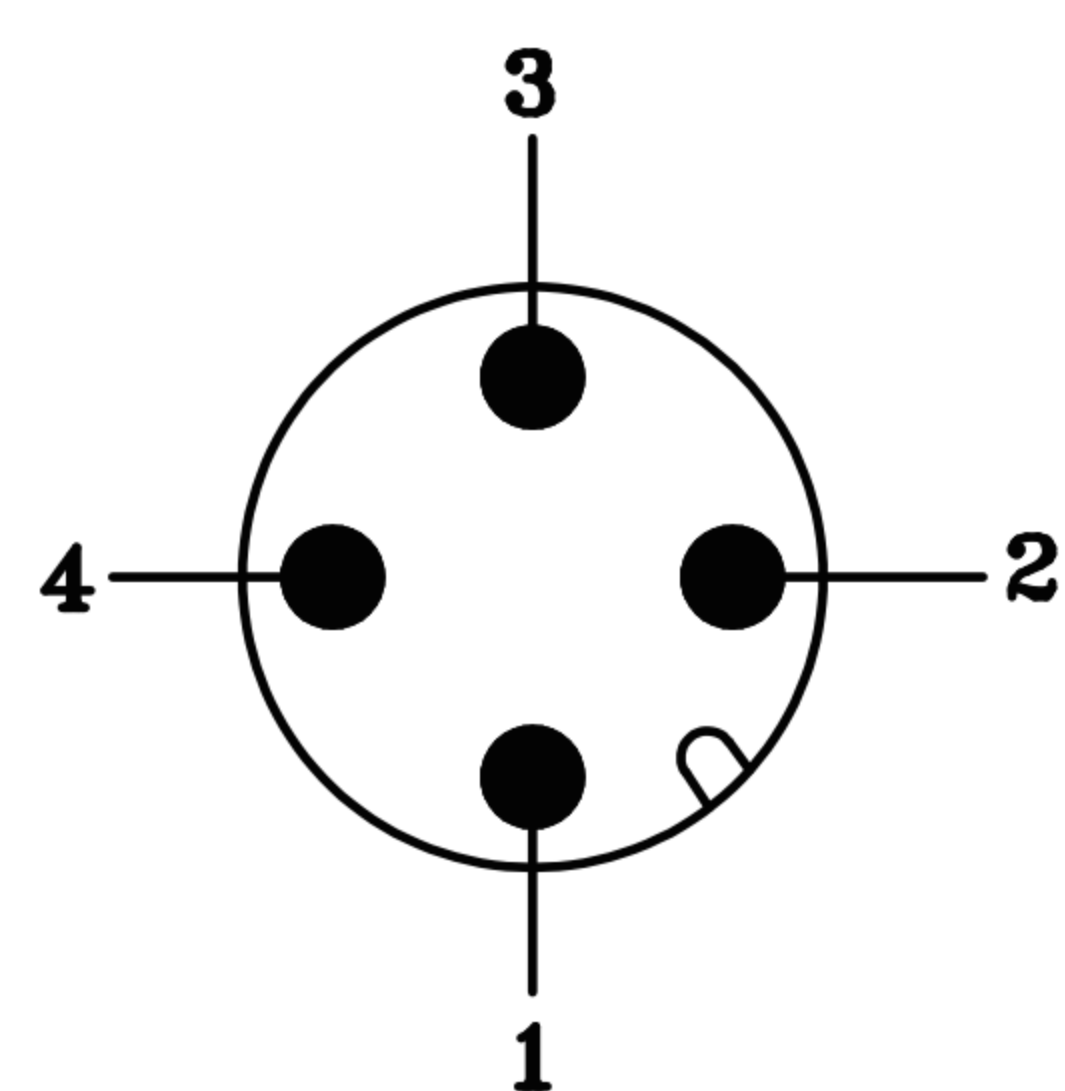

Pin	Interface Function
1	Power supply 24V+
2	Auxiliary power supply 24V+
3	Power supply GND
4	Data communication(IO-Link)

IO Interface

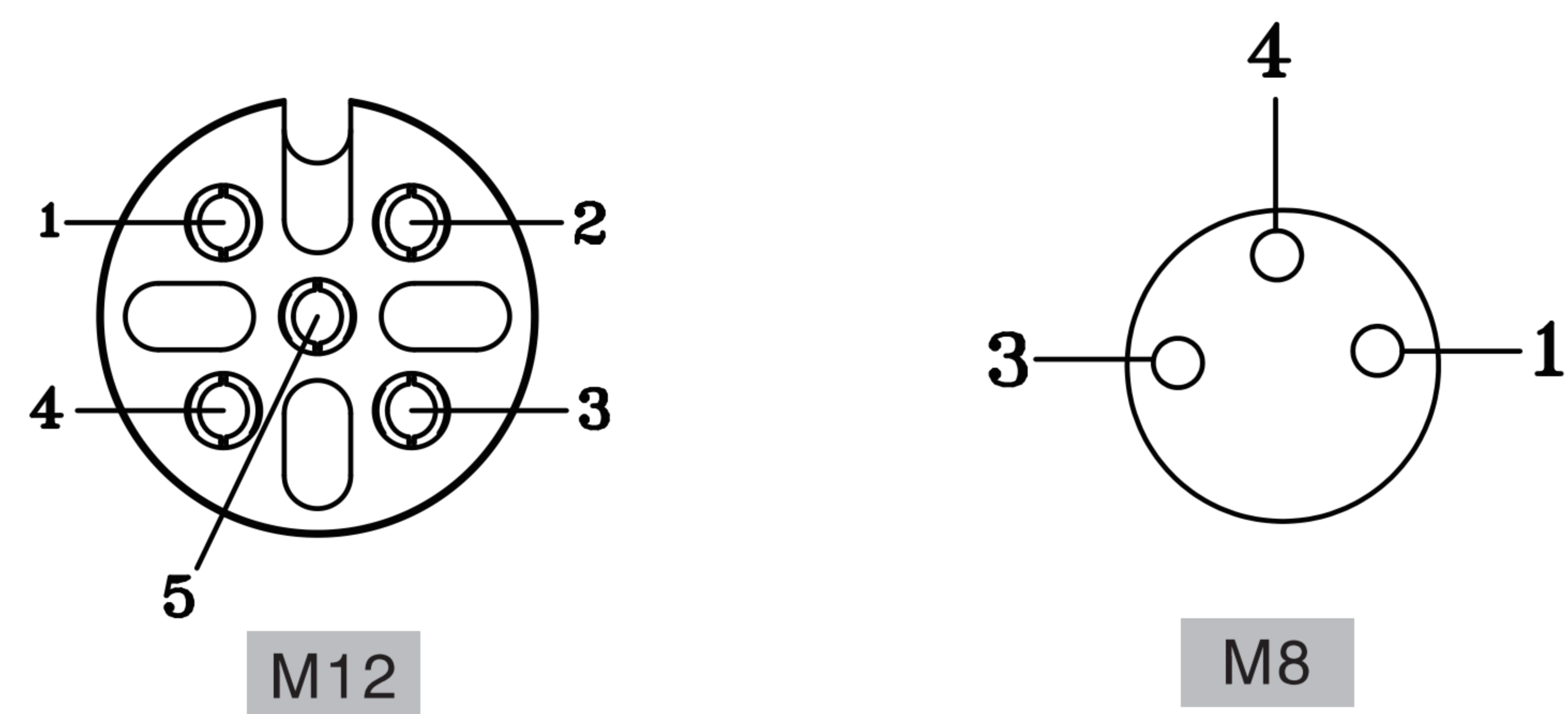

Pin	M12 Signal Connection	M8 Signal Connection
1	Power supply 24V+	Power supply 24V+
2	Signal input/output B	Second signal /
3	Power supply GND	Power supply GND
4	Signal input/output A	First signal
5	Shield earthing PE	/

Specifications

IO-Link Input/Output Modules-M12

Model	ESLK-1600P-M12	ESLK-088UP-M12	ESLK-16UP-M12
Description	16DI, Class A, 8*M12(PNP)	8DI+8DIO, Class A, 8*M12(PNP)	16DI/DO, Class A, 8*M12(PNP)
Model	ESLK-1600N-M12	ESLK-088UN-M12	ESLK-16UN-M12
Description	16DI, Class A, 8*M12(NPN)	8DI+8DIO, Class A, 8*M12(NPN)	16DI/DO, Class A, 8*M12(NPN)
Connection IO-Link	1XM12 male A-Code 4pin		
Connection the power supply	Expansion port contains power supply		
Connection I/O ports	8XM12 female A-Code 5pin		
Input channel number	16	Max. 16	Max. 16
Input current	Max. 200 mA		
Input signal type	Sensor, magnet switch, reed switch		
Input filter delay	1.6ms		
Output channel number	-	Max. 8	Max. 8
Output supply current	Each channel Max 0.5A, Total ≤ 2A		
Output signal type	Indicators, Micro solenoid valve		
Input switching frequency	Resistive load 100Hz, inductive load 5Hz		
Equipment diagnosis	Communication message feedback, undervoltage alarm, short circuit/overload protection		
Degree of protection	IP67		
Temperature	Ambient temperature -25°C-70°C, Storage temperature -40°C-85°C		

IO-Link Input/Output Modules-M8

Model	ESLK-0800P-M8	ESLK-08P-M8
Description	8DI, Class A, 8*M8(PNP)	8DI/DO, Class A, 8*M8(PNP)
Model	ESLK-0800N-M8	ESLK-08N-M8
Description	8DI, Class A, 8*M8(NPN)	8DI/DO, Class A, 8*M8(NPN)
Connection IO-Link	1XM12 male A-Code 4pin	
Connection the power supply	Expansion port contains power supply	
Connection I/O ports	8XM8 female A-Code 3pin	
Number of digital inputs	8	Max. 8
Input current	Max. 200 mA	
Input signal type	Sensor, magnet switch, reed switch	
Input filter delay	1.6ms	
Output channel number	-	Max. 8
Output supply current	Each channel Max 0.5A, Total ≤ 2A	
Output signal type	Indicators, Micro solenoid valve	
Input switching frequency	Resistive load 100Hz, inductive load 5Hz	
Equipment diagnosis	Communication message feedback, undervoltage alarm, short circuit/overload protection	
Degree of protection	IP67	
Temperature	Ambient temperature -25°C-70°C, Storage temperature -40°C-85°C	

Wiring

M8 male connecting cable

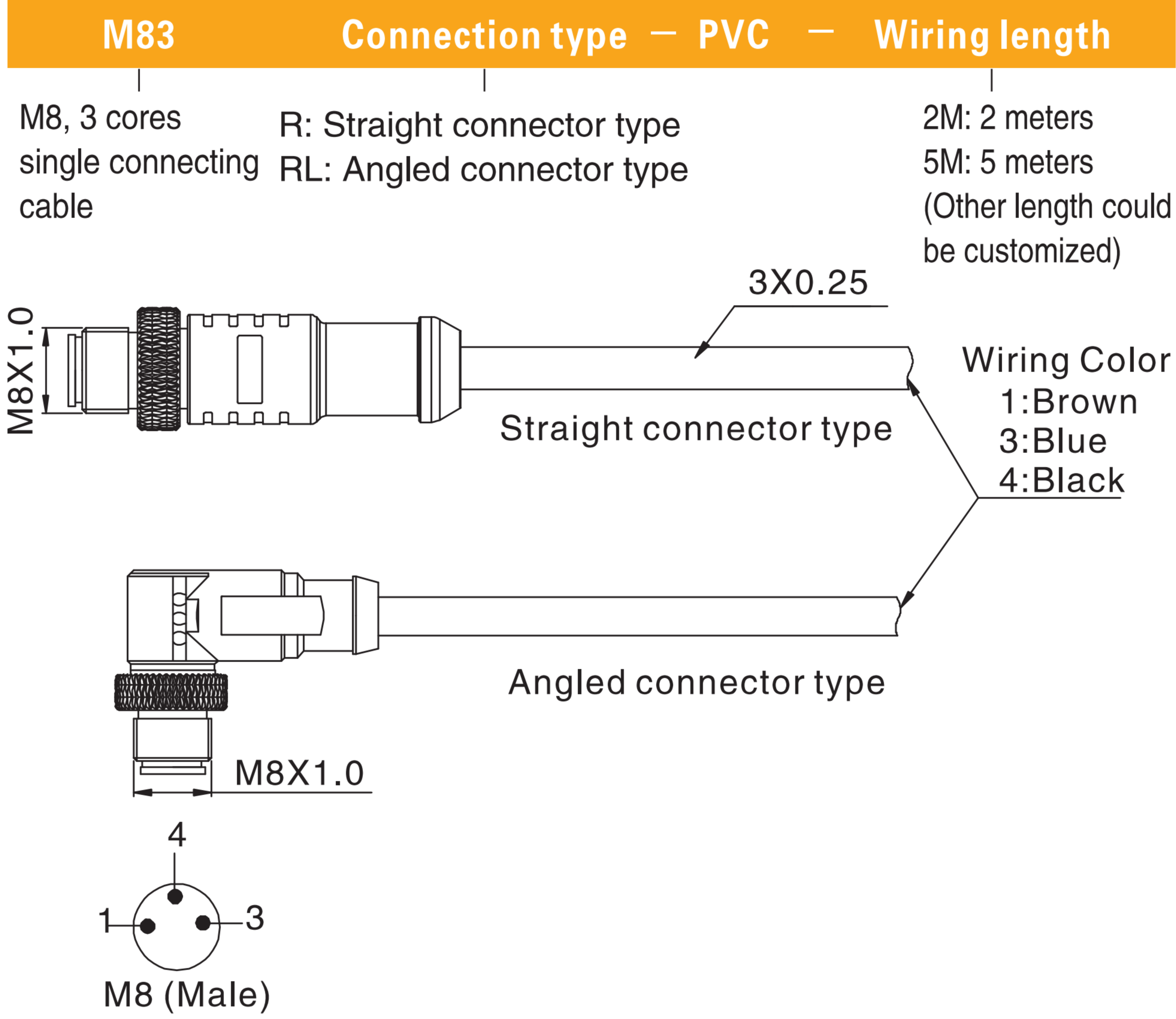

M8 double connecting cable

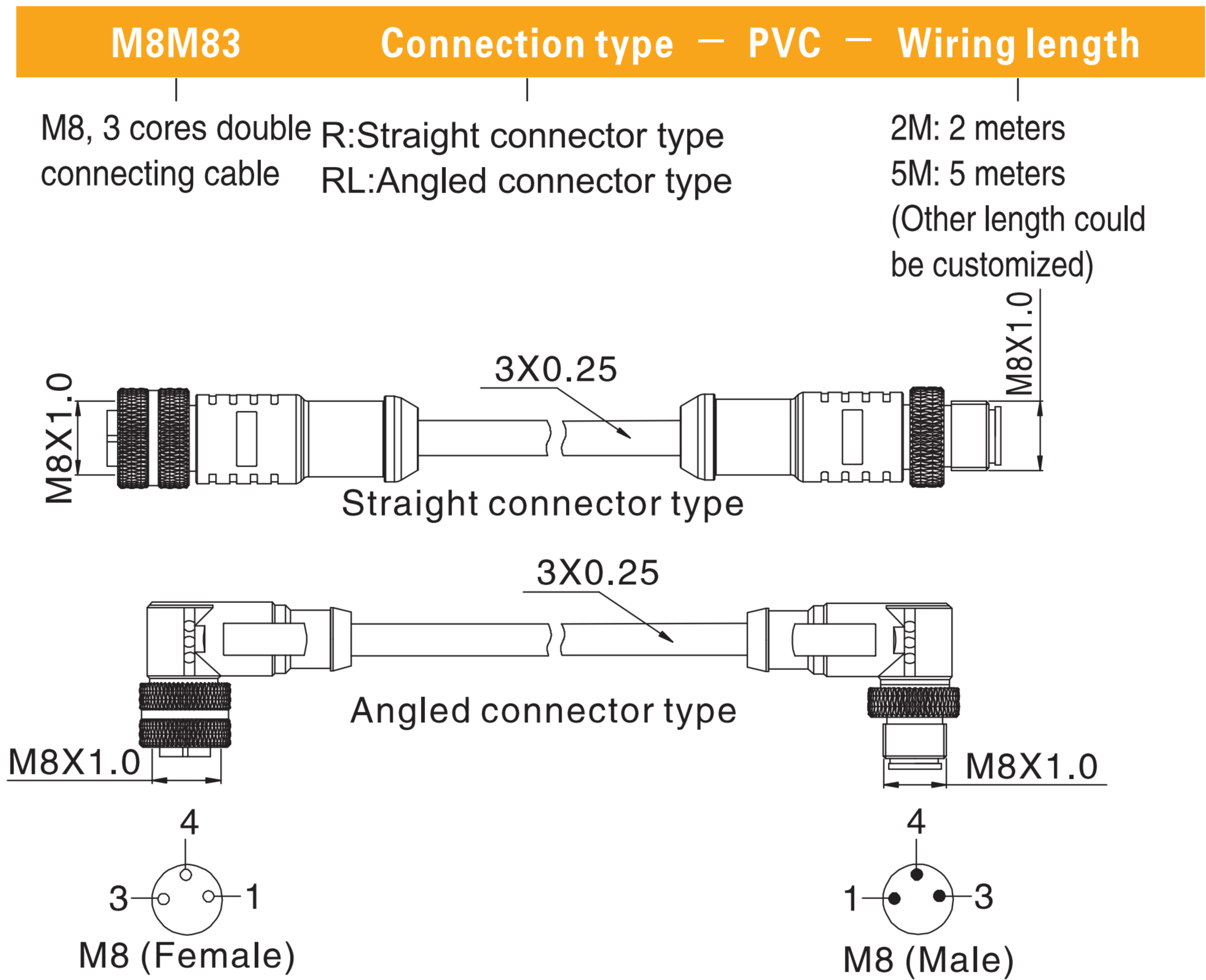

IO-Link connector cable

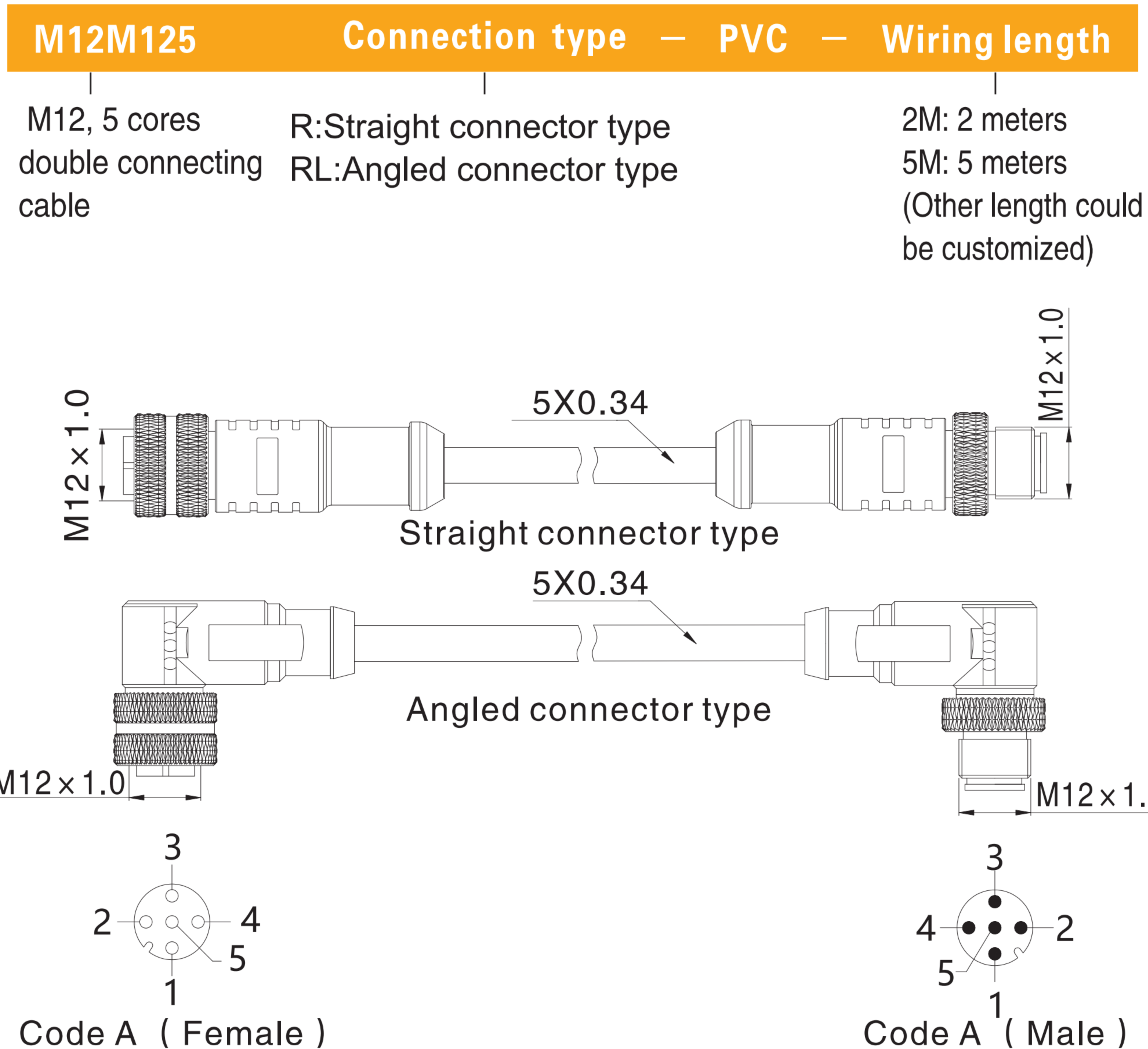

Y-type branch connector

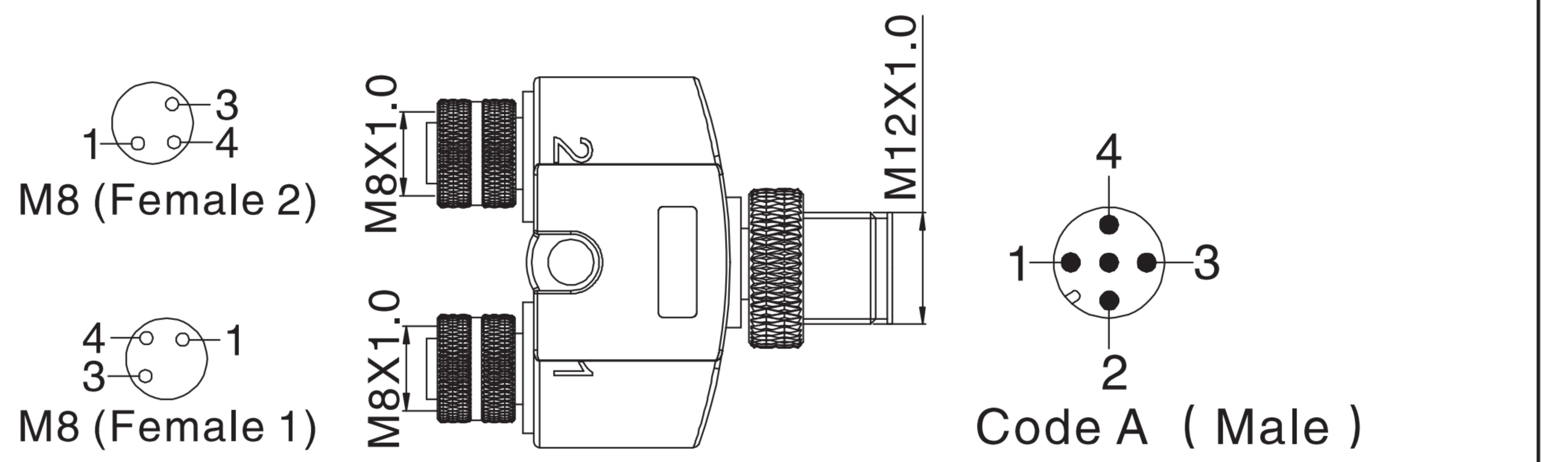
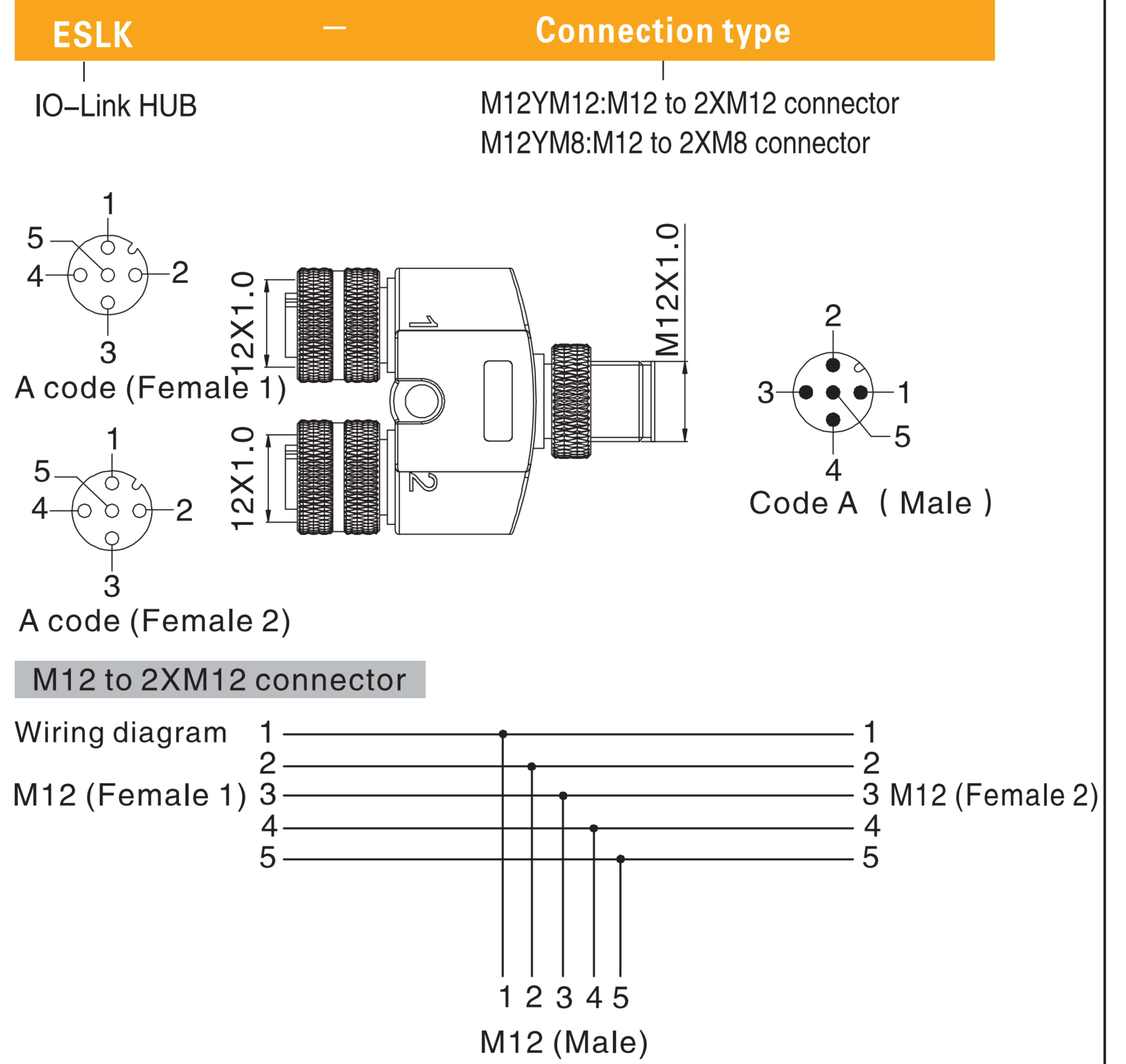

M12 to 2XM8 connector

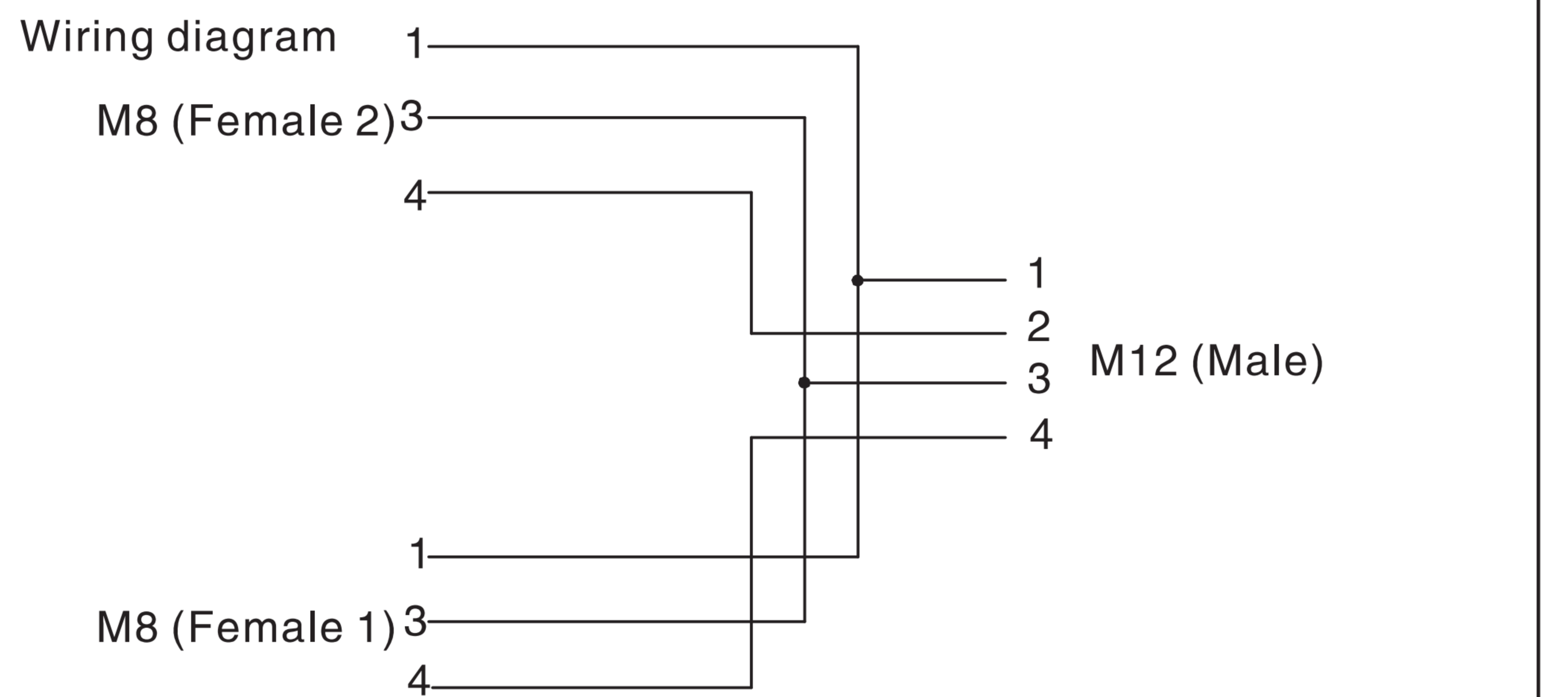

3-pin Connector (M8)

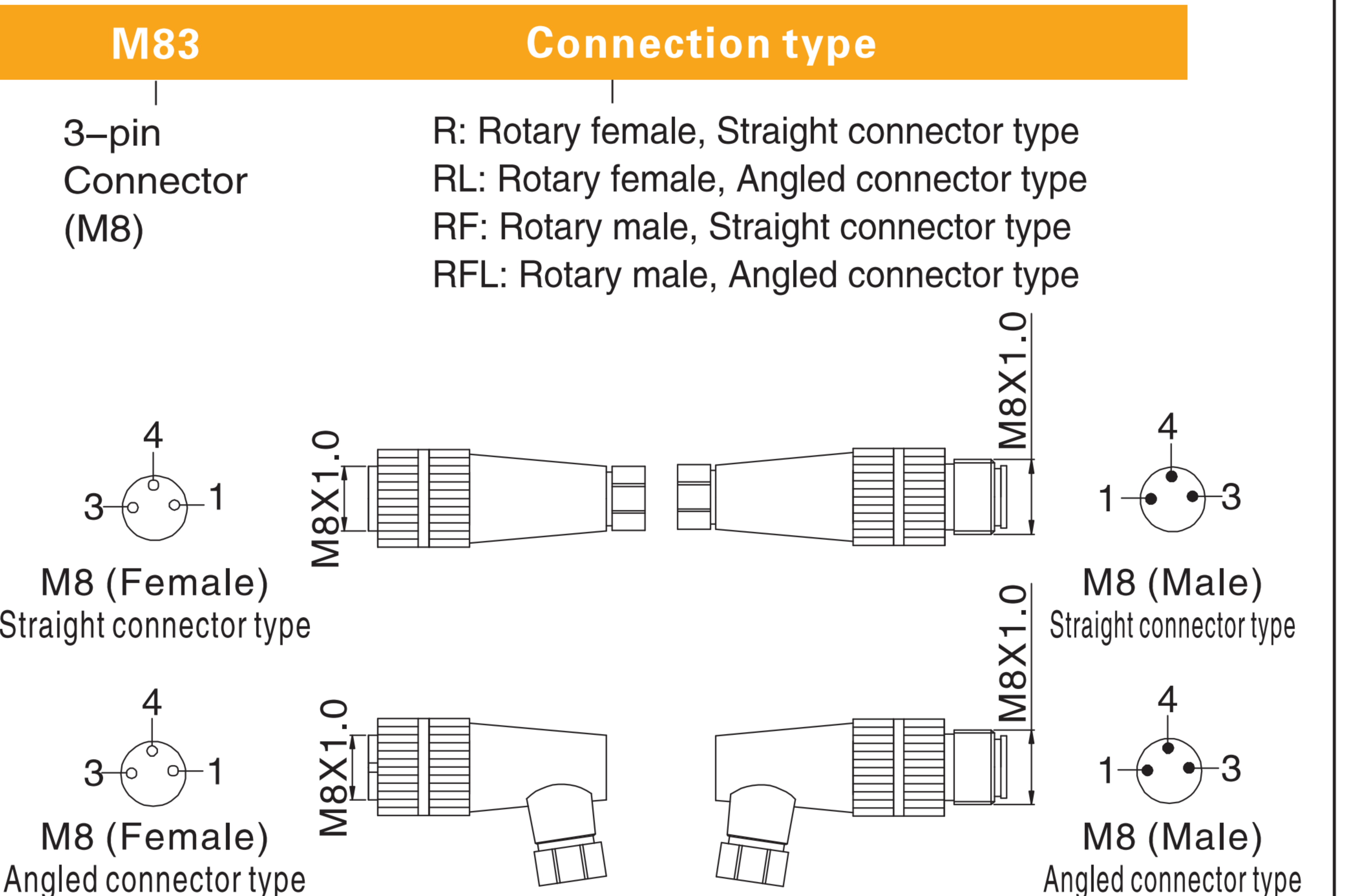

IO Wiring Diagram

PNP dual input

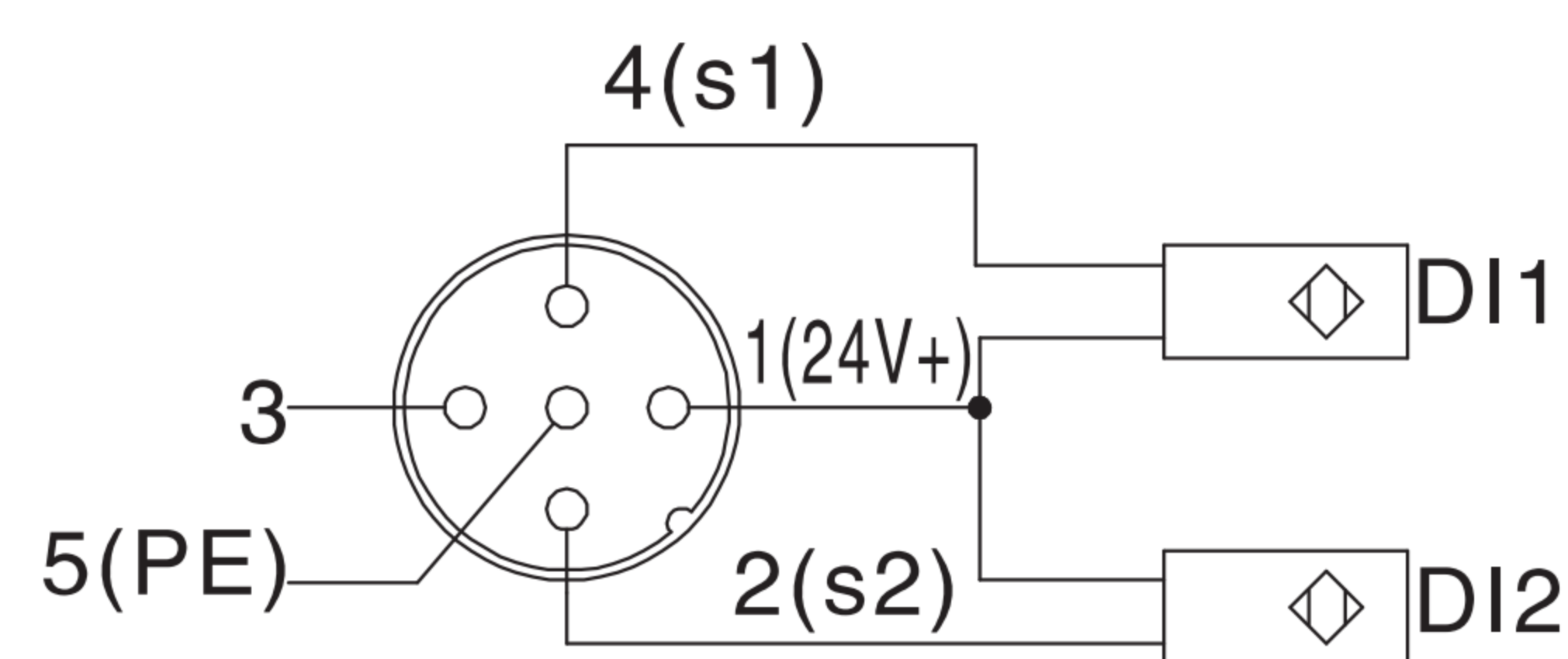

PNP dual output

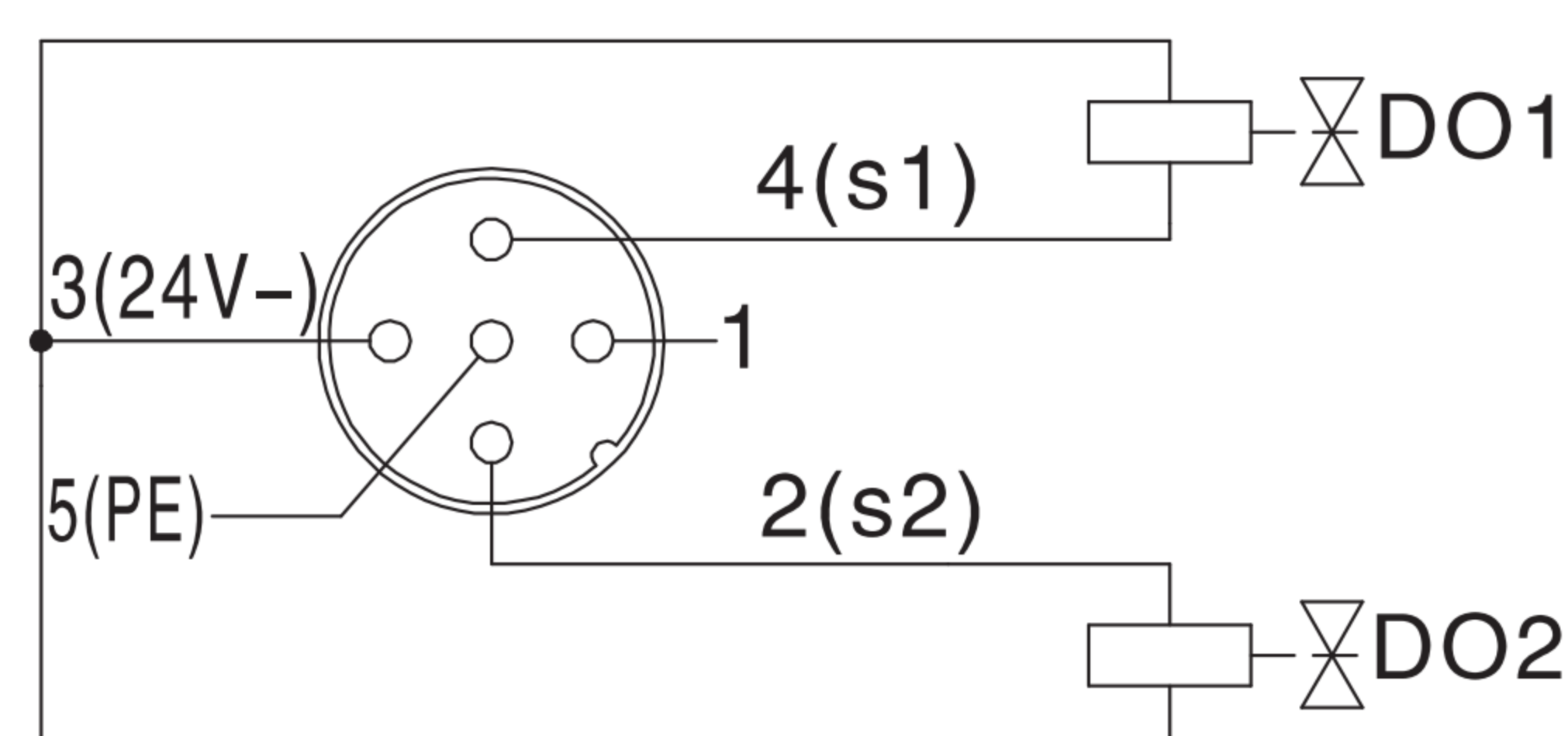

PNP input and output

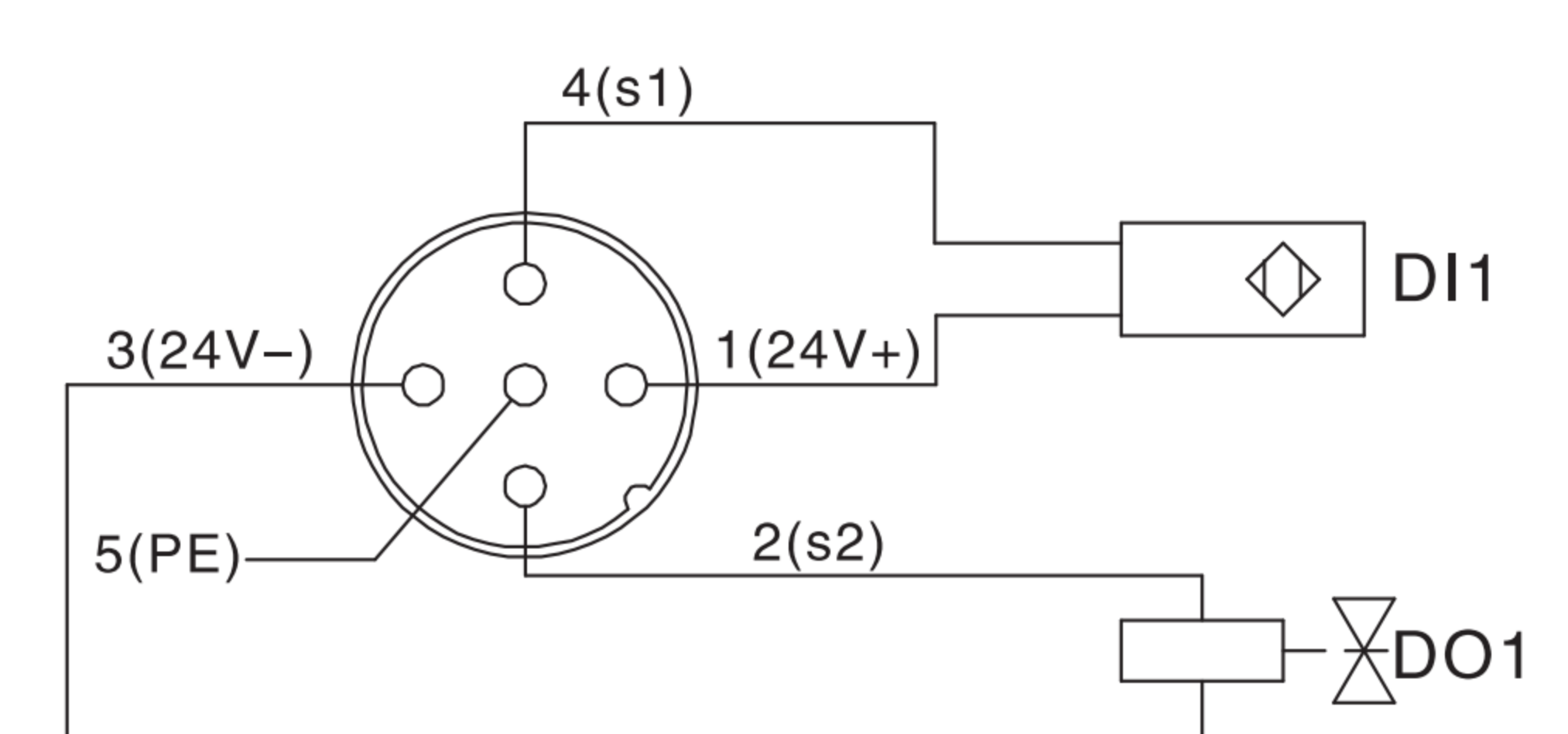

NPN dual input

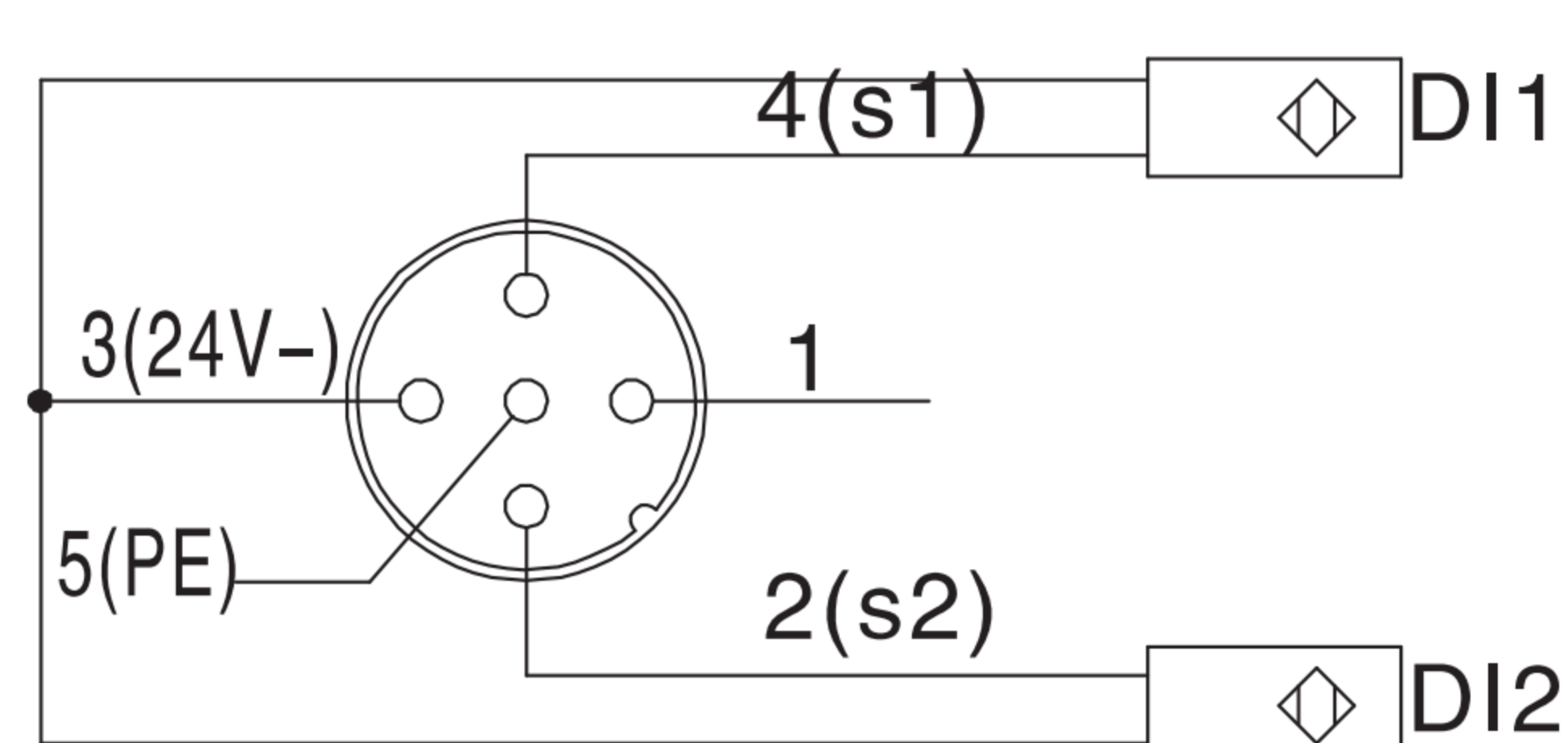

NPN dual output

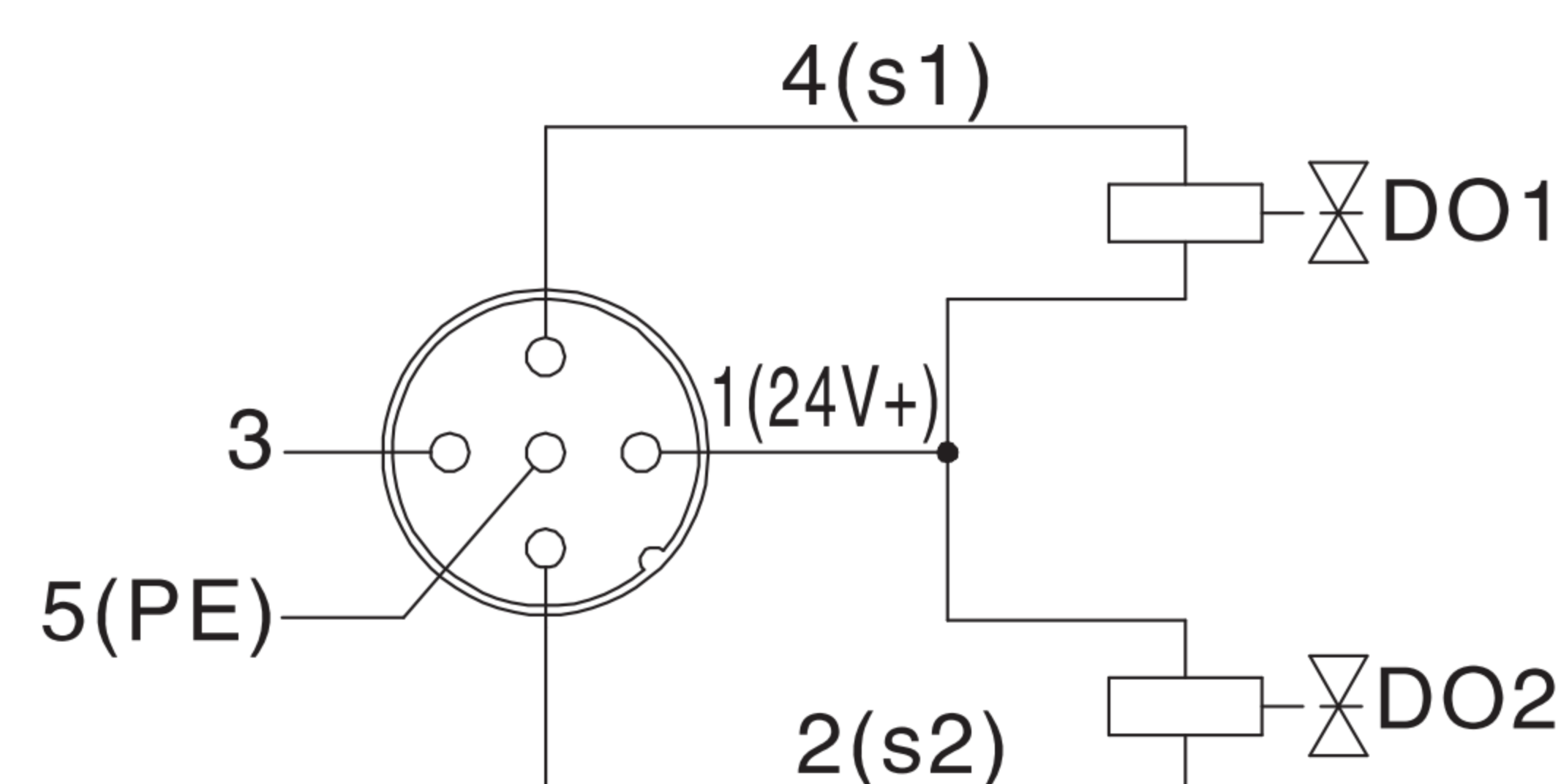

NPN input and output

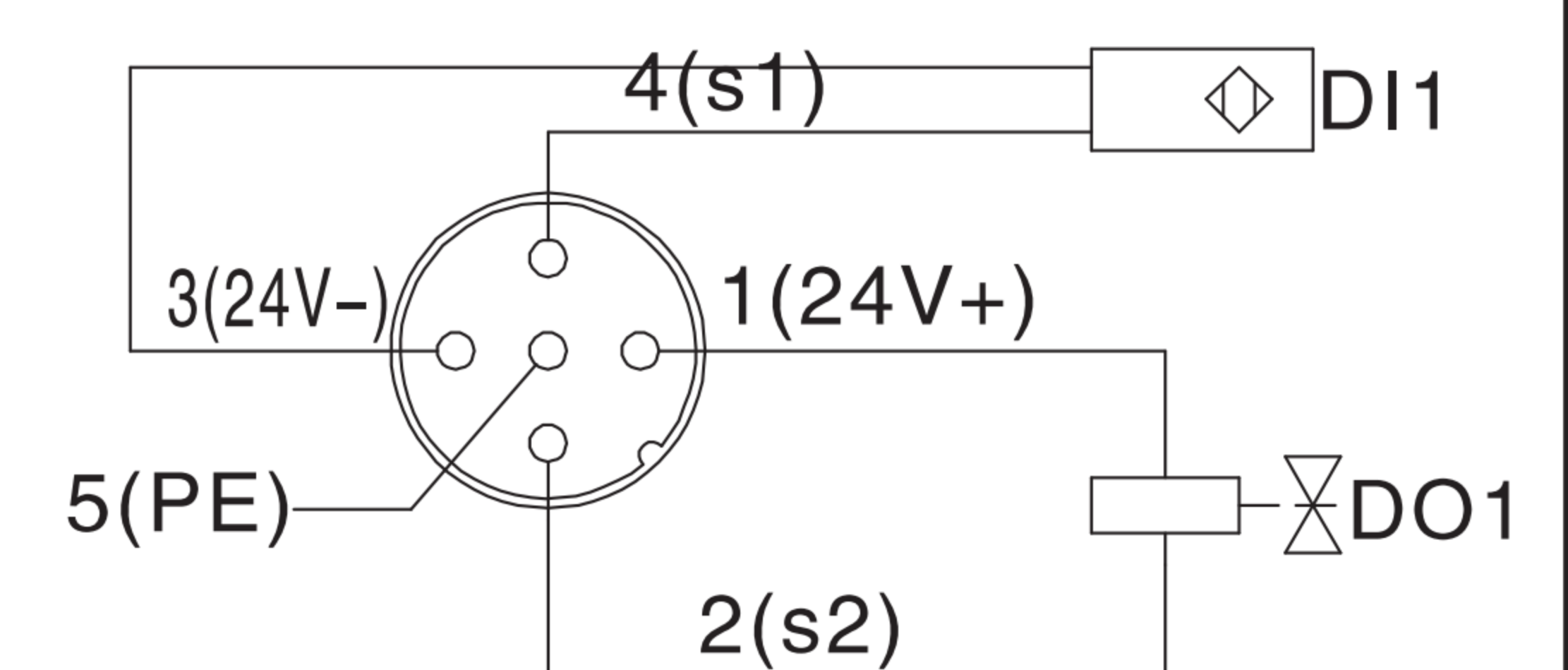

PNP input

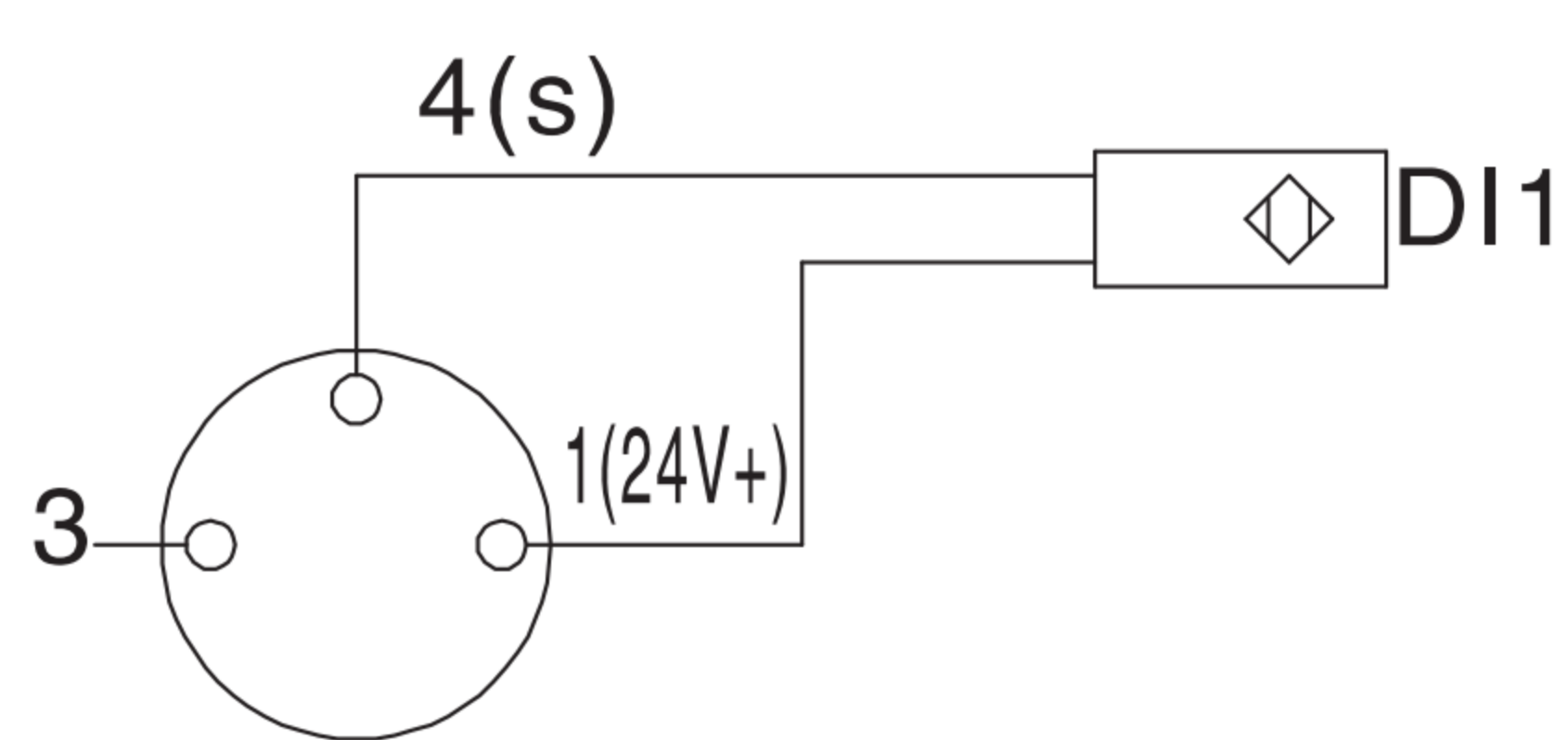

PNP output

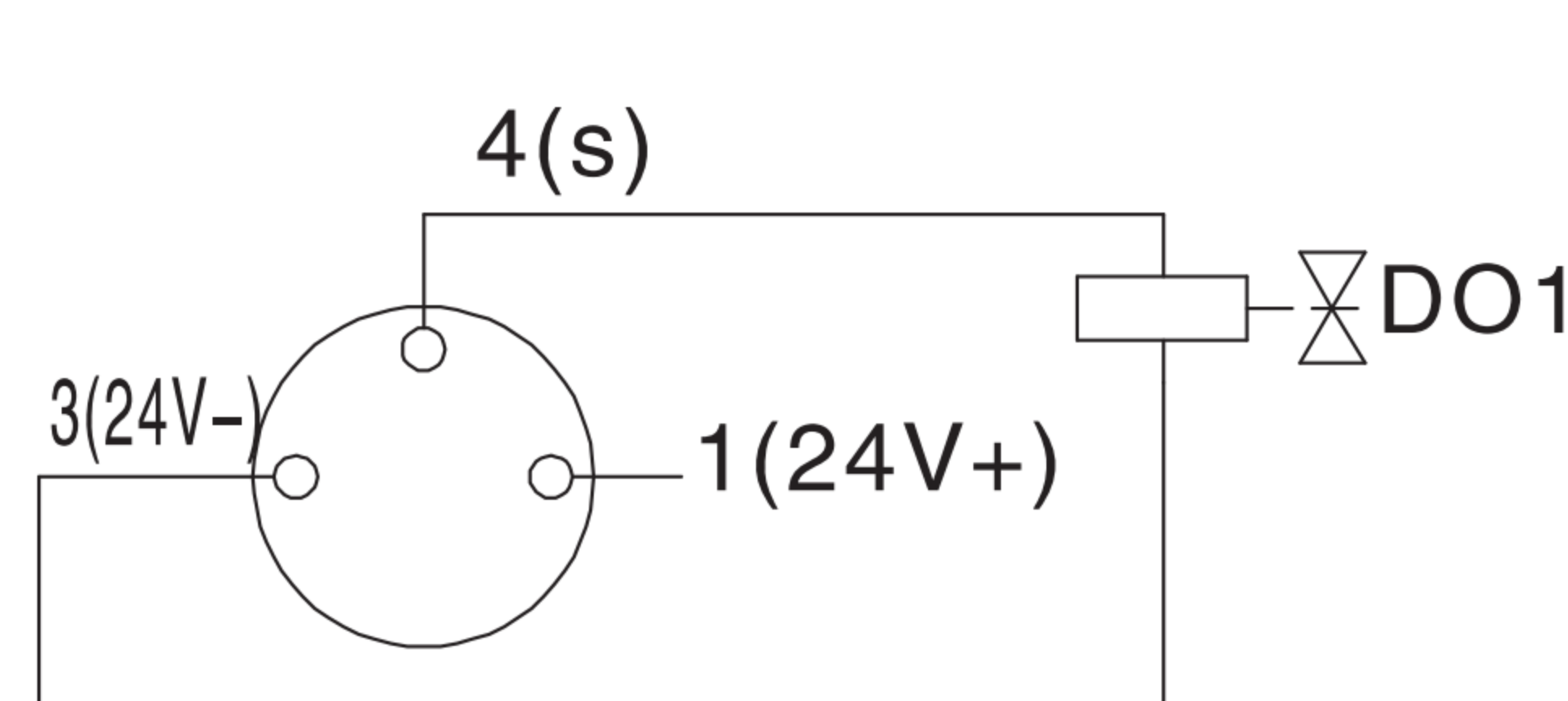

NPN input

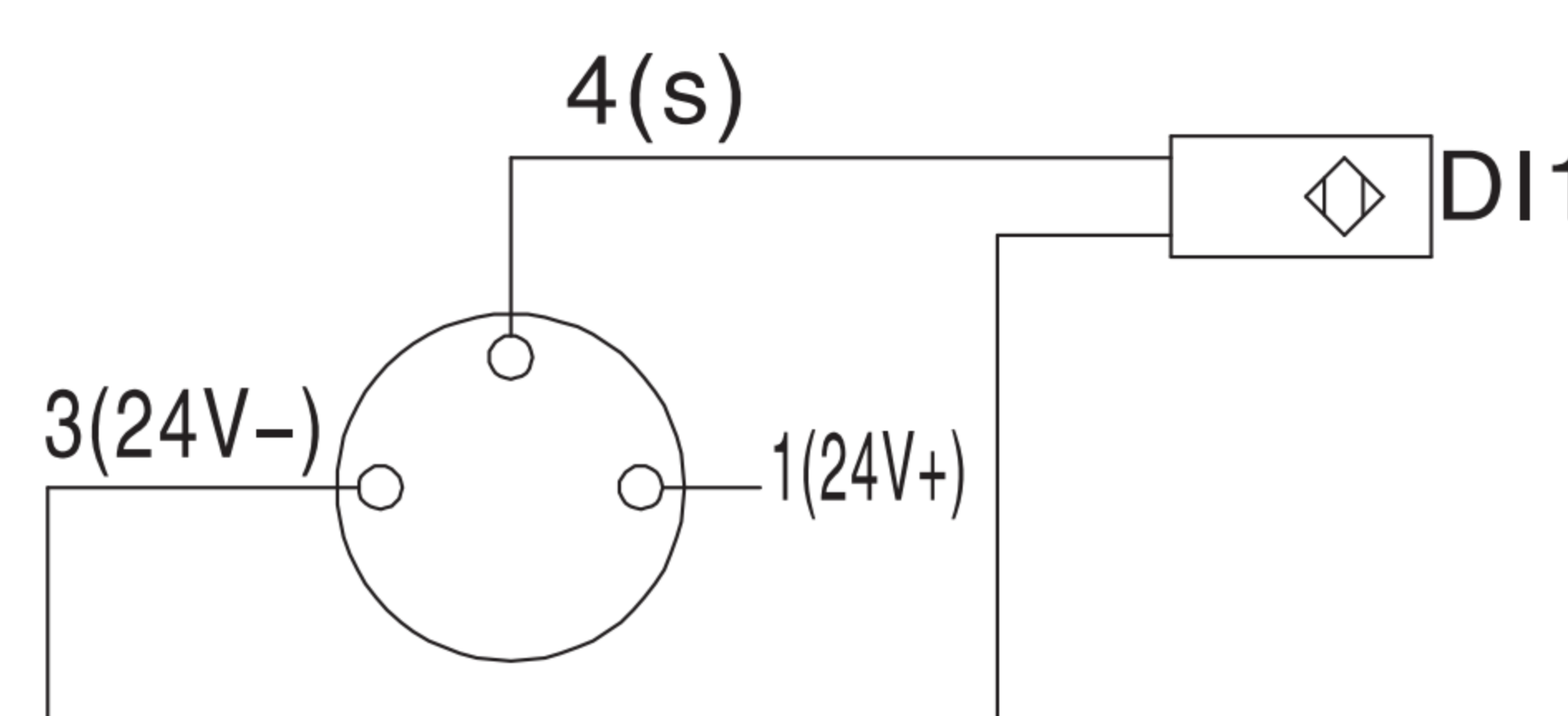

NPN output

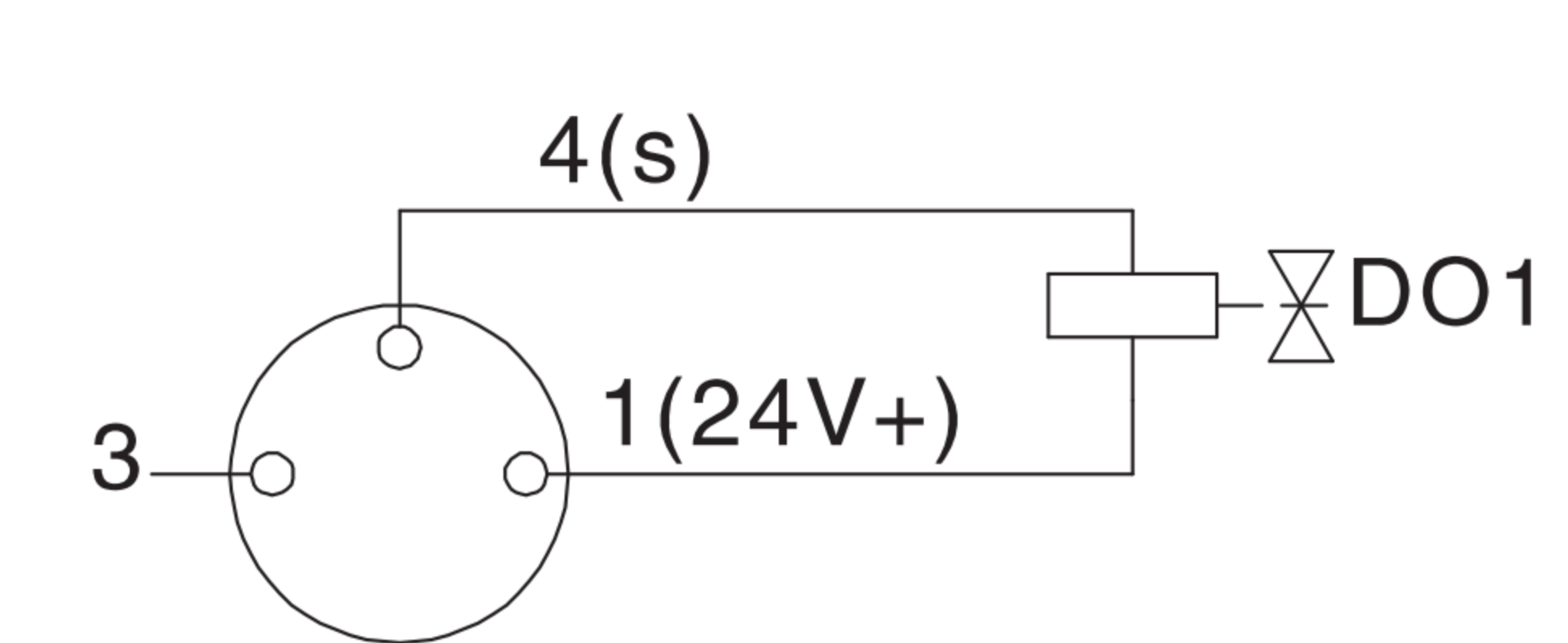

Precautions for Use

1. Do not disassembly, modify (including replacing printed circuit boards) or replace without authorization, which may result injury or failure.
2. Do not operate the product exceeding the parameters (limited value), and do not use it for flammable or harmful liquids, which may cause fire, malfunction or damage to the product. Please verify the instructions before use.
3. Please connect according to the basic electrical specifications. For personal and equipment safety, it is recommended to disconnect the power supply during the wiring operation.
4. Connecting the module to the protective earthing can release the interference current underground and ensure the safety and E·MC compatibility of the module.
5. Ensure a low impedance connection to the protective earthing.

Main Dimension

IO-Link Input/Output Modules-M12

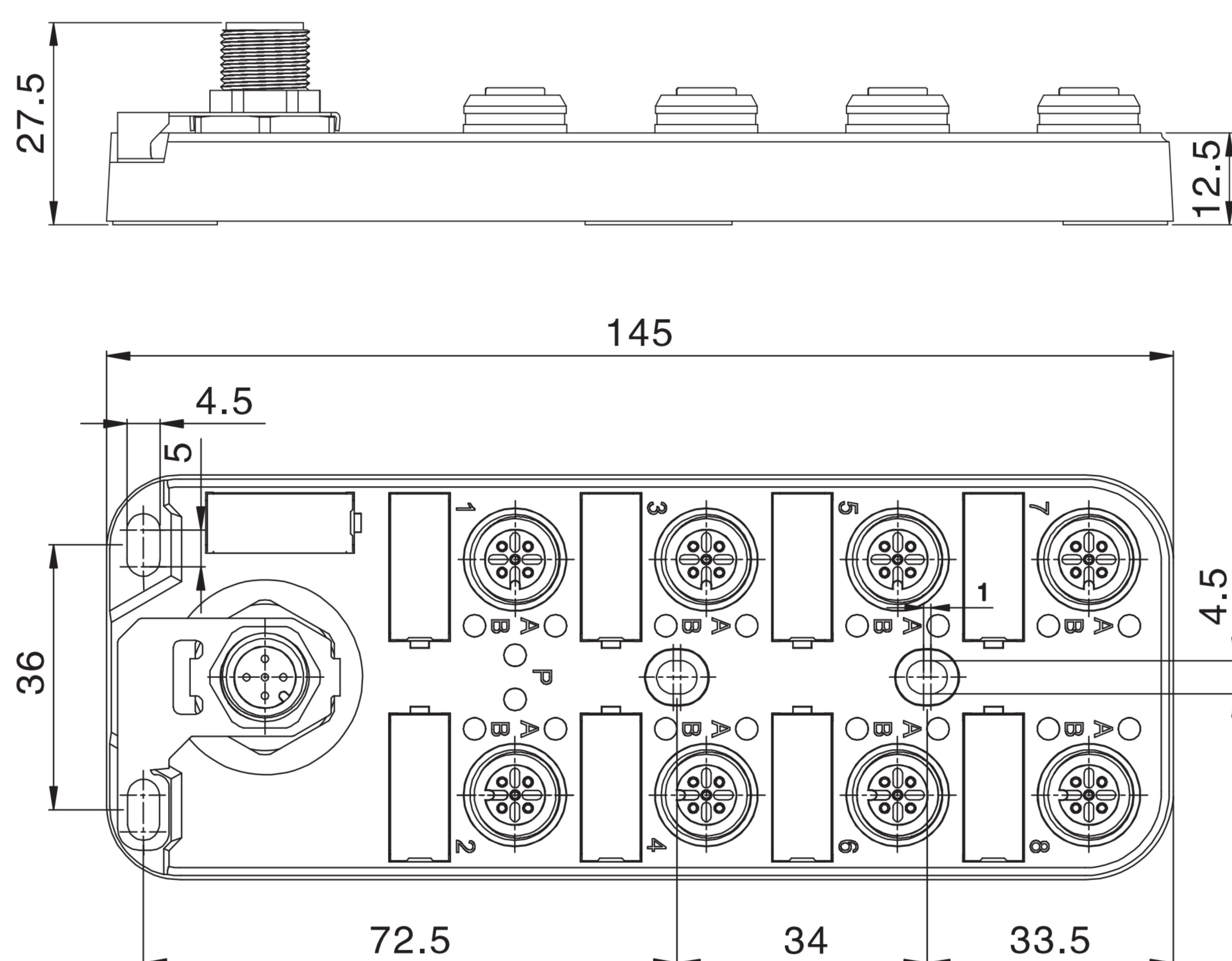

IO-Link Input/Output Modules-M8

